



**Insulator, flange:
stainless steel,
DN 40 ISO-KF**



PFEIFFER 

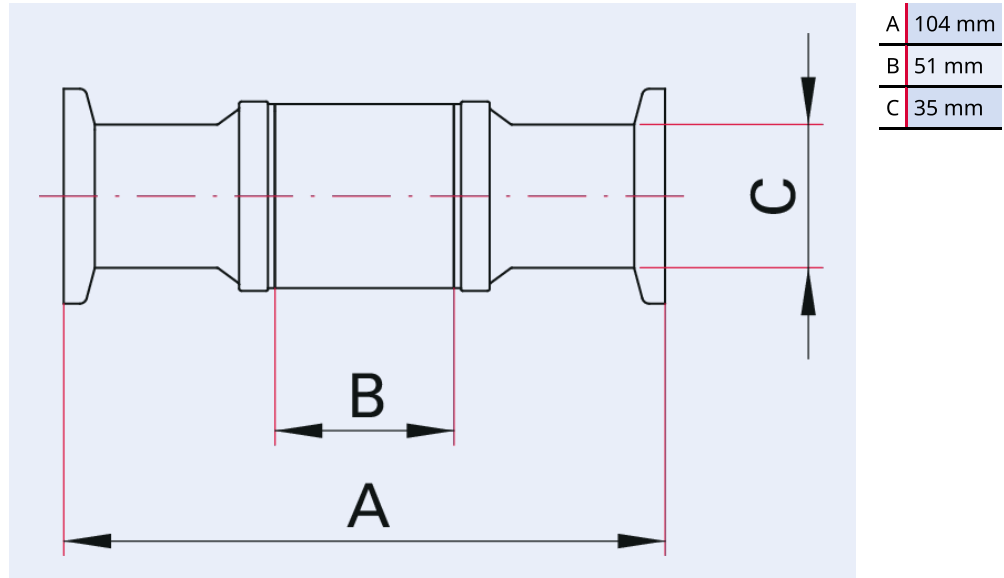

Illustration only

Insulator, flange: stainless steel, DN 40 ISO-KF

- Stainless steel flange
- The specified voltages and currents refer to the following ambient conditions:
room temperature, outside: dry air, inside: vacuum $< 1 \cdot 10^{-4}$ hPa

Dimensions



Technical Data	Insulator, flange: stainless steel, DN 40 ISO-KF
Materials in contact with media	Flange: Stainless steel
Temperature range	0 – 250 °C
Tightness	1 · 10 ⁻¹¹ Pa m ³ /s 7.5 · 10 ⁻¹¹ Torr l/s 1 · 10 ⁻¹⁰ mbar l/s
Heat up and cool down rate	≤20 K/min
Feedthrough voltage	30 kV DC
Connection flange	DN 40 ISO-KF
Pressure range	1 · 10 ⁻⁸ hPa – to ambient pressure
Temperature range max.	250 °C 482 °F 523.15 K
Temperature range min.	0 °C 32 °F 273.15 K

Order number	Insulator, flange: stainless steel, DN 40 ISO-KF
Insulator, flange: stainless steel, DN 40 ISO-KF	120XIS040-30



Errors and/or changes excepted. - 5/14/2025

Are you looking for an optimum vacuum solution?

Talk to us:

Pfeiffer Vacuum Components & Solutions GmbH Germany

T +49 551 99963-0

info-cs@pfeiffer-vacuum.com

Or scan the barcode, to visit our web page:



<https://webportal.pfeiffer-vacuum.com/global/en/contact>

Follow Us On Social Media

#pfeiffervacuum



www.pfeiffer-vacuum.com

PFEIFFER 