



**Glass flange, quartz
glass, DN 40 ISO-KF**



PFEIFFER 

Glass blank flange

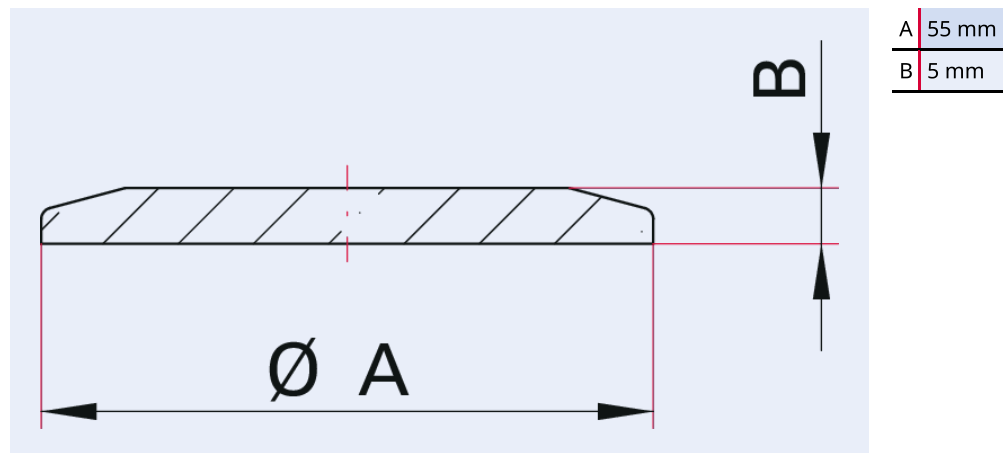

Illustration only

Glass flange, quartz glass, DN 40 ISO-KF

- Installation with outer centering ring and elastomer seal
- Fastening elements: Clamping ring made from plastic (no usage of metal connection elements)
- Caution! Risk of injury by glass splinters. Do not use viewports which show apparent damage

Dimensions



Technical Data

| | Glass flange, quartz glass, DN 40 ISO-KF |
|---------------------------------|--|
| Materials in contact with media | Quartz glass |
| Temperature range | 15 - 200 °C |
| Heat up and cool down rate | ≤5 K/min |
| Connection flange | DN 40 ISO-KF |
| Pressure range | 1 · 10 ⁻⁸ hPa - 5 · 10 ² hPa over pressure |
| Temperature range max. | 200 °C 392 °F 473.15 K |
| Temperature range min. | 15 °C 5 °F 258.15 K |

| Order number | Glass flange, quartz glass, DN 40 ISO-KF |
|--|---|
| Glass flange, quartz glass, DN 40 ISO-KF | 180FBL040 |



Errors and/or changes excepted. - 5/14/2025

Are you looking for an optimum vacuum solution?
Talk to us:
Pfeiffer Vacuum Components & Solutions GmbH Germany
T +49 551 99963-0
info-cs@pfeiffer-vacuum.com

Or scan the barcode, to visit our web page:



<https://webportal.pfeiffer-vacuum.com/global/en/contact>

Follow Us On Social Media
#pfeiffervacuum



www.pfeiffer-vacuum.com

PFEIFFER 