



# Electrical feedthrough, 14 kV, 50 A, 2 pins, DN 16 CF

---



**PFEIFFER**

# Electrical feedthrough

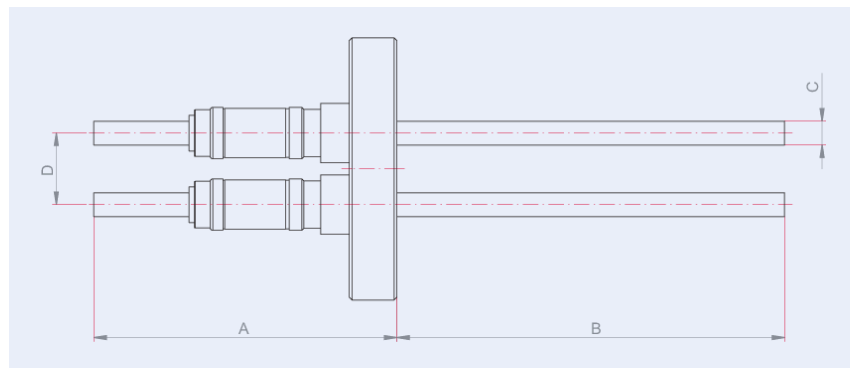

Illustration only

## Electrical feedthrough, 14 kV, 50 A, 2 pins, DN 16 CF

- Flange material: Stainless steel
- Conductor material: copper
- Conductor material stainless steel, molybdenum, nickel on request
- The specified voltages and currents refer to the following ambient conditions:  
room temperature, outside: dry air, inside: vacuum  $< 1 \cdot 10^{-4}$  hPa

## Dimensions



|   |        |
|---|--------|
| A | 67 mm  |
| B | 117 mm |
| C | 2.4 mm |

| <b>Technical Data</b>           | <b>Electrical feedthrough, 14 kV, 50 A, 2 pins,<br/>DN 16 CF</b>  |
|---------------------------------|---|
| Materials in contact with media | Flange: Stainless steel, Conductor: Copper  |
| Temperature range (vacuum side) | 100 – 300 °C  |
| Tightness                       | 1 · 10 <sup>-11</sup> Pa m <sup>3</sup> /s   7.5 · 10 <sup>-11</sup> Torr l/s  <br>1 · 10 <sup>-10</sup> mbar l/s |
| Heat up and cool down rate      | ≤20 K/min   |
| Feedthrough voltage             | 14 kV DC  |
| Current                         | 50 A  |
| Pins                            | 2   |
| Connection flange               | DN 16 CF  |
| Pressure range                  | 1 · 10 <sup>-11</sup> hPa – to ambient pressure   |

| <b>Order number</b>                                      | <b>Electrical feedthrough, 14 kV, 50 A, 2 pins,<br/>DN 16 CF</b> |
|--|--|
| Electrical feedthrough, 14 kV, 50 A, 2 pins,<br>DN 16 CF | 420XST016-10-30-2  |



Errors and/or changes excepted. - 5/14/2025

Are you looking for an optimum vacuum solution?

Talk to us:

**Pfeiffer Vacuum Components & Solutions GmbH Germany**

**T +49 551 99963-0**

**info-cs@pfeiffer-vacuum.com**

Or scan the barcode, to visit our web page:



<https://webportal.pfeiffer-vacuum.com/global/en/contact>

Follow Us On Social Media

#pfeiffervacuum



[www.pfeiffer-vacuum.com](http://www.pfeiffer-vacuum.com)

**PFEIFFER** 