

Electrical feedthrough, 12 kV, 180 A, 1 pin, DN 25 ISO-KF



PFEIFFER 

Electrical feedthrough

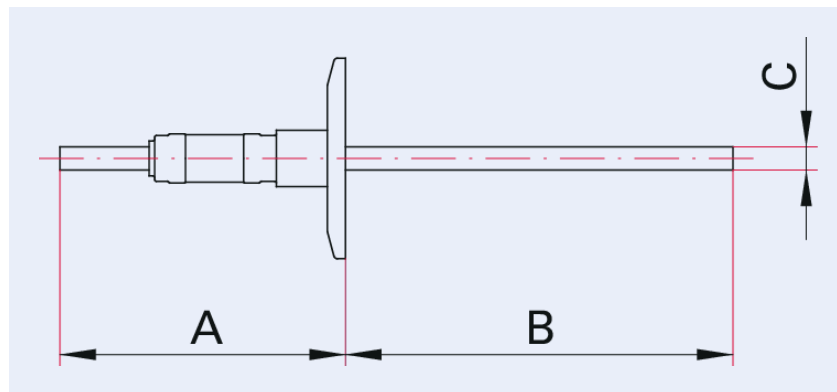

Illustration only

Electrical feedthrough, 12 kV, 180 A, 1 pin, DN 25 ISO-KF

- Flange material: Stainless steel
- Conductor material: copper
- Conductor material stainless steel, Ni on request
- The specified voltages and currents refer to the following ambient conditions:
room temperature, outside: dry air, inside: vacuum $< 1 \cdot 10^{-4}$ hPa

Dimensions



A	80 mm
B	105 mm
C	6.35 mm

Technical Data	Electrical feedthrough, 12 kV, 180 A, 1 pin, DN 25 ISO-KF
Materials in contact with media	Flange: Stainless steel, Conductor: Copper
Temperature range (vacuum side)	100 – 300 °C
Tightness	1 · 10 ⁻¹¹ Pa m ³ /s 7.5 · 10 ⁻¹¹ Torr l/s 1 · 10 ⁻¹⁰ mbar l/s
Heat up and cool down rate	≤20 K/min
Feedthrough voltage	12 kV DC
Current	180 A
Pins	1
Connection flange	DN 25 ISO-KF
Pressure range	1 · 10 ⁻⁸ hPa – to ambient pressure

Order number	Electrical feedthrough, 12 kV, 180 A, 1 pin, DN 25 ISO-KF
Electrical feedthrough, 12 kV, 180 A, 1 pin, DN 25 ISO-KF	120XST025-5-150-1



Errors and/or changes excepted. - 5/14/2025

Are you looking for an optimum vacuum solution?

Talk to us:

Pfeiffer Vacuum Components & Solutions GmbH Germany

T +49 551 99963-0

info-cs@pfeiffer-vacuum.com

Or scan the barcode, to visit our web page:



<https://webportal.pfeiffer-vacuum.com/global/en/contact>

Follow Us On Social Media

#pfeiffervacuum



www.pfeiffer-vacuum.com

PFEIFFER 