

**Fluid feedthrough,
double tube, stainless
steel, DN 40 CF**



PFEIFFER 

Fluid feedthrough, double tube

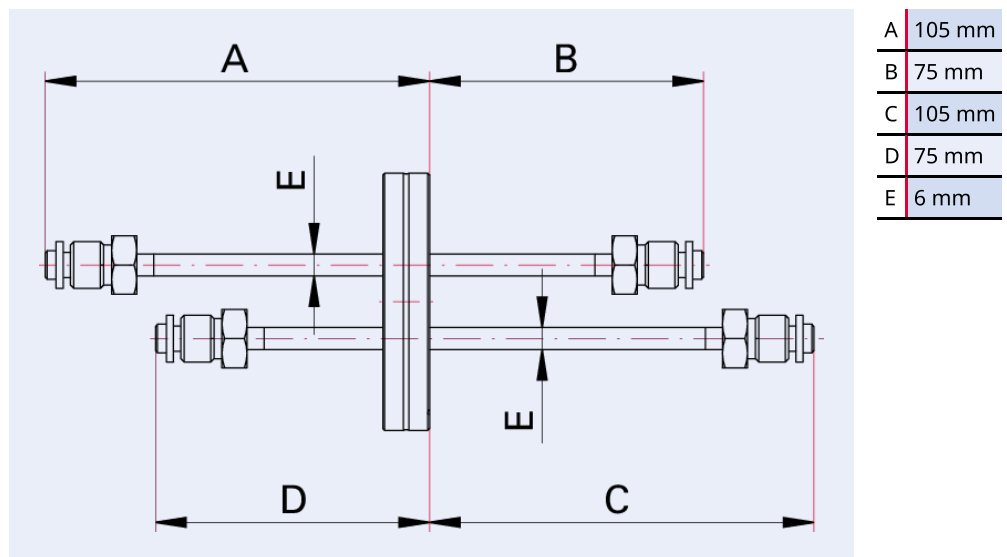

Illustration only

Fluid feedthrough, double tube, stainless steel, DN 40 CF

- Flange material: Stainless steel
- V = VCR male 1/4"

Dimensions



Technical Data	Fluid feedthrough, double tube, stainless steel, DN 40 CF
Materials in contact with media	Stainless steel
Temperature range (vacuum side)	196 – 300 °C
Vacuum side	V
Atmosphere side	V
Tightness	1 · 10 ⁻¹¹ Pa m ³ /s 7.5 · 10 ⁻¹¹ Torr l/s 1 · 10 ⁻¹⁰ mbar l/s
Connection flange	DN 40 CF
Pressure range	1 · 10 ⁻¹¹ hPa – to ambient pressure

Order number	Fluid feedthrough, double tube, stainless steel, DN 40 CF
Fluid feedthrough, double tube, stainless steel, DN 40 CF	420XFL040-2-VV

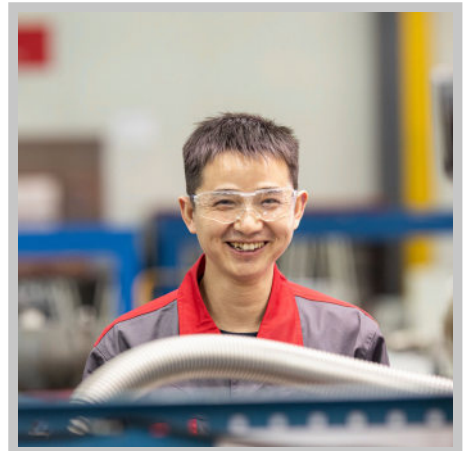

Errors and/or changes excepted. - 5/14/2025

Are you looking for an optimum vacuum solution?
Talk to us:
Pfeiffer Vacuum Components & Solutions GmbH Germany
T +49 551 99963-0
info-cs@pfeiffer-vacuum.com

Or scan the barcode, to visit our web page:



<https://webportal.pfeiffer-vacuum.com/global/en/contact>

Follow Us On Social Media
#pfeiffervacuum



www.pfeiffer-vacuum.com

PFEIFFER 